

APPLICATION FORM FOR A MODIFICATION TO THE COUNTY OF DORSET DEFINITIVE MAP AND STATEMENT OF RIGHTS OF WAY Wildlife and Countryside Act 1981

To: Director For Environment and the Economy
Dorset County Council
County Hall
DORCHESTER
Dorset
DT1 1XJ

I/We (i) ALLINGTON PARISH COUNCIL
of (ii) ALLINGTON, BRIDPORT 1/0 5 HIGHER ST, BRADDOLE, BRIDPORT, DORSET
hereby apply for an order under Section 53(2) of the Wildlife and Countryside Act 1981 modifying the Definitive Map and Statement for the area by *:-

(a) **Deleting** the *footpath / bridleway / restricted byway / byway open to all traffic ** which runs from: _____

to: _____

(b) **Adding** the *footpath / bridleway / restricted byway / byway open to all traffic ** which runs from: DONKEY LANE

to: COURT ORCHARD

(c) **Upgrading/downgrading** to a *footpath / bridleway / restricted byway / byway open to all traffic ** the *footpath / bridleway / byway open to all traffic* which runs from: _____

to: _____

(d) **Varying/adding** to the particulars relating to the *footpath / bridleway / restricted byway / byway open to all traffic ** from: _____

to: _____

by providing that _____

and shown on the map accompanying this application (see overleaf).

N.B. PLEASE DESCRIBE ROUTE AND STATE WIDTHS WHERE APPROPRIATE

I/We attach copies of the following documentary evidence [including statements of witnesses] in support of this application:-

(iii) STATEMENTS OF WITNESSES

Signed: SIGNATURE REDACTED _____ Date: 21/3/16

- (i) Insert name of applicant(s)
- (ii) Insert address of applicant(s)
- (iii) Insert list of documents
- * Delete as appropriate

PLEASE ATTACH A MAP SHOWING THE PRECISE LINE OF THE ROUTE USED AND SIGN IT



**CERTIFICATE OF SERVICE OF NOTICE OF APPLICATION FOR MODIFICATION ORDER
THE COUNTY OF DORSET DEFINITIVE MAP AND STATEMENT OF RIGHTS OF WAY**

Wildlife and Countryside Act 1981

To: Director for Environment and the Economy
Dorset County Council
County Hall
Colliton Park
DORCHESTER
Dorset
DT1 1XJ

We(i) ALLINGTON PARISH COUNCIL
of (ii) 90 5 HIGHER ST, BRADPOLE, BRIDPORT, DORSET

hereby certify that the requirements of paragraph 2 of Schedule 14 to the Wildlife and Countryside Act 1981 have been complied with in relation to the attached application.

Signed: SIGNATURE REDACTED _____ Date: 21/3/16

NOTES FOR GUIDANCE

This certificate should be completed only when notice of the application has been served on all owners and occupiers affected by the proposal. A list of the names and addresses of all individuals notified should be provided below. Please indicate if you have been unable to identify all owners and occupiers of any land to which the application relates.

Notice of Application Sent To:

| Name | Address |
|----------------------------|--|
| 1. <u>MR RAMMOND</u> | <u>MEADOWSIDE, DONKEY LANE, BRIDPORT</u> |
| 2. <u>MR HUTCHINGS</u> | <u>DUNSTER FARM, BROADOAK, BRIDPORT</u> |
| 3. <u>OWNERS</u> | <u>224 NORTH ALLINGTON, BRIDPORT</u> |
| 4. <u>OWNERS/OCCUPIERS</u> | <u>75B COURT ORCHARD ROAD, BRIDPORT</u> |
| 5. _____ | _____ |
| 6. _____ | _____ |

(i) Insert name of applicant(s) (ii) Insert address of applicant(s)

PLEASE ATTACH A MAP SHOWING THE PRECISE LINE OF THE ROUTE USED AND SIGN IT

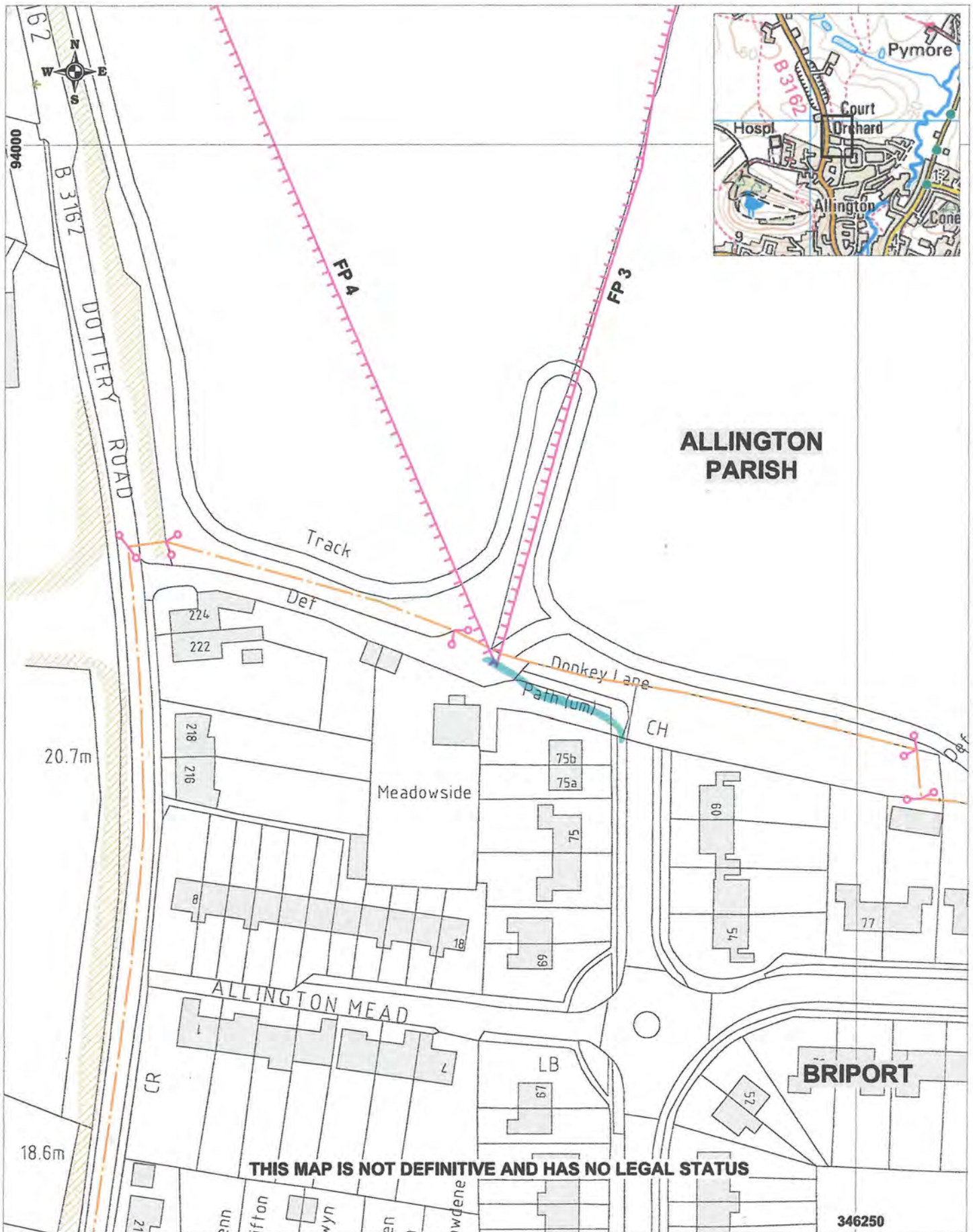

DONKEY LANE, BRIDPORT

SIGNATURE REDACTED

AMY STEPHANSON
PARISH CLERK

Ref:

Date: 03/03/2016

Scale: 1:1000

Drawn By:

Cent X: 346175

Cent Y: 93904

GEOGRAPHICAL INFORMATION SYSTEMS



Dorset County Council

© Crown copyright and database rights 2016 Ordnance Survey 100019790. You are permitted to use this data solely to enable you to respond to, or interact with, the organisation that provided you with the data. You are not permitted to copy, sub-licence, distribute or sell any of this data to third parties in any form. Aerial Photography © UK Perspectives 2002 © Getmapping 2005, 2009 & 2014

APPLICATION FOR PERMISSION TO NOTIFY LANDOWNERS BY SITE NOTICE

Wildlife and Countryside Act 1981

To: Director for Environment and the Economy
Dorset County Council
County Hall
Colliton Park
DORCHESTER
Dorset
DT1 1XJ

PATH LOCATION DETAILS:

PARISH: BRIDPORT / ALLINGTON DISTRICT: _____

CLAIMED STATUS OF WAY: Footpath / Bridleway / Restricted byway / Byway Open to All Traffic [delete as appropriate].

DESCRIPTION OF PATH [include a map]:

FROM: DONKEY LANE

TO: COURT ORCHARD

CURRENT RECORDED STATUS ON DEFINITIVE MAP: No status recorded / Footpath / Bridleway / Restricted Byway / Byway Open To All Traffic [delete as appropriate]

I/WE (i) ALLINGTON PARISH COUNCIL

of (ii) 40 5 HILGHER ST, BRADPOLE, BRIDPORT, DORSET

have carried out an investigation in an attempt to discover the owners and occupiers of the land affected by the application. I have made enquiries of: [delete those that are not applicable].

- * Adjoining landowners
- * Local inhabitants
- * Post Office
- * Parish Council
- * Register of Electors
- * Land Registry
- * Other appropriate sources [please state].

I have been unable to discover ownership of the land, and I request the County Council to direct that Notice may be served by posting said Notices at either end of the way claimed. I FEEL IT WOULD BE WISE TO PUT UP NOTICES

Signed: SIGNATURE REDACTED Date: 21/3/16

(i) Insert name of applicant(s) (ii) Insert address of applicant(s)

PLEASE ATTACH A MAP SHOWING THE PRECISE LINE OF THE ROUTE USED AND SIGN IT

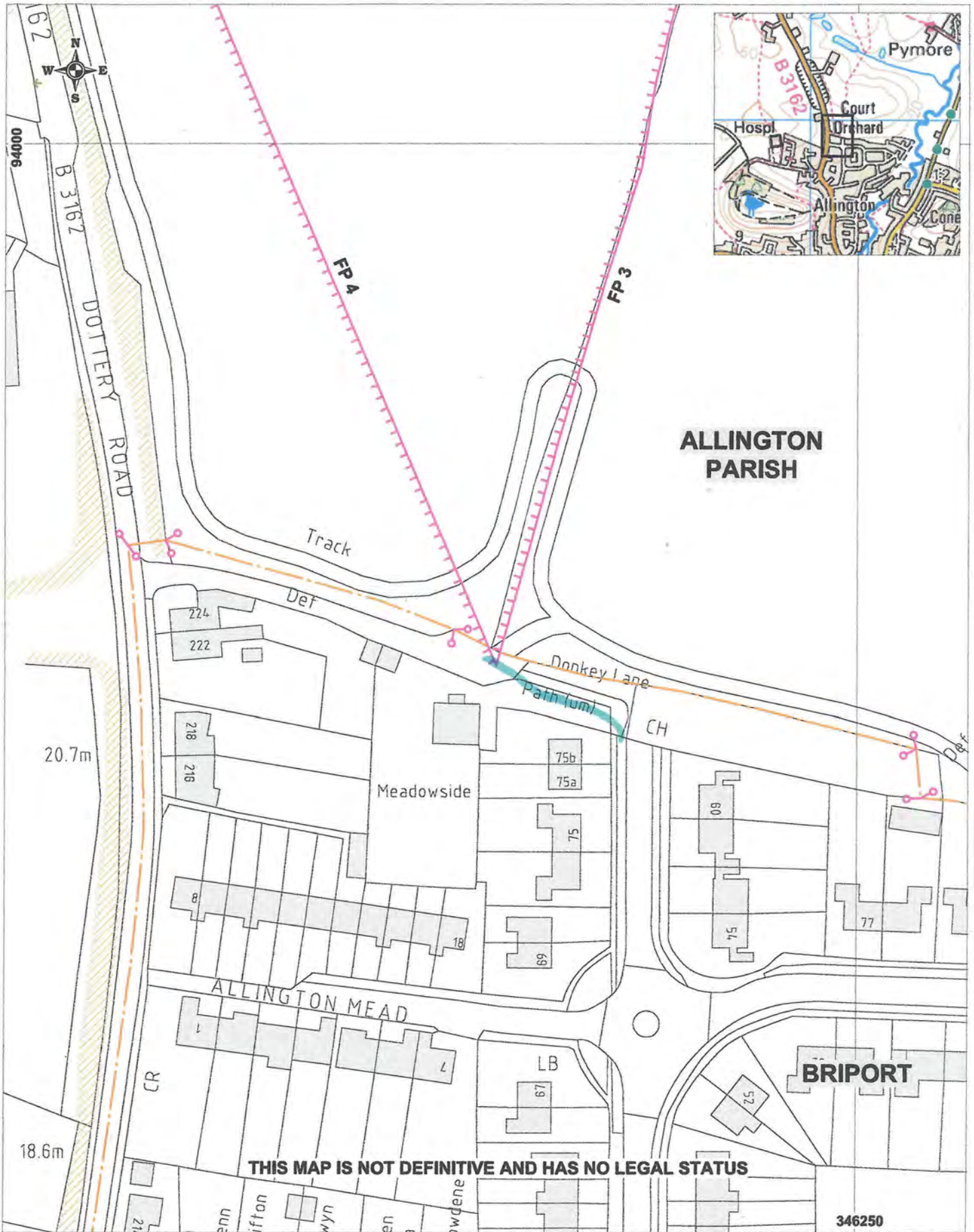

DONKEY LANE, BRIDPORT

SIGNATURE REDACTED

AMY STEPHENSON
PARISH CLERK

Ref:

Date: 03/03/2016

Scale: 1:1000

Drawn By:

Cent X: 346175

Cent Y: 93904

GEOGRAPHICAL INFORMATION SYSTEMS



Dorset County Council

© Crown copyright and database rights 2016 Ordnance Survey 100019790. You are permitted to use this data solely to enable you to respond to, or interact with, the organisation that provided you with the data. You are not permitted to copy, sub-licence, distribute or sell any of this data to third parties in any form. Aerial Photography © UK Perspectives 2002 © Getmapping 2005, 2009 & 2014